

Address: 228 W SMITH ST

Owner: PEREZ LUIS ET CASTILLA OLGA J

Parcel: 07023072000400

Parcel Profile

Address 228 | W | SMITH | ST

Street Status PAVED | SIDEWALK

School District CORRY AREA SCHOOL

Acreage 0.1148

Classification R

Land Use Code SINGLE FAMILY

Legal Description 228 W SMITH ST TR 51 50X100

Square Feet 1116

Topo ROLLING

Utility ALL PUBLIC

Zoning Please contact your municipal zoning officer

Deed Book 2021

Deed Page 001857

2024 Tax Values

Land Value / Taxable 12,600 / 12,600.00

Building Value / Taxable 31,780 / 31,780.00

Total Value / Taxable 44,380 / 44,380.00

Clean & Green Inactive

Homestead Status Inactive

Farmstead Status Inactive

Lerta Amount 0

Lerta Expiration Year 0

Residential Data

Card 1

Style OLD STYLE

Basement PART

Year Built 1900

Exterior Wall	COMPOSITION
Total Living Area	1116
Full Baths	2
Half Baths	0
Fuel Type	GAS
Heating	CENTRAL
Heating System	HOT WATER
Stories	2.0
Total Bedrooms	3
Total Family Rooms	0
Total Rooms	6
Fireplaces	0

Other Buildings & Yards

No OBY Data Found

Sales History

Sale Date	From	To	Type	Price	Book / Page	Other Info
1/26/2021	FIRST NATIONAL BANK OF PENNSYLVANIA	PEREZ LUIS ET CASTILLA OLGA J	LAND & BUILDING	18000	2021 / 001857	SPECIAL WARRANTY DEED
5/20/2020	BABCOCK DOROTHY A	FIRST NATIONAL BANK OF PENNSYLVANIA	LAND & BUILDING	10	2020 / 008815	DEED
6/4/1985			LAND & BUILDING	18000	0158 / 2278	

Parcel Sketches

Residential Card 1

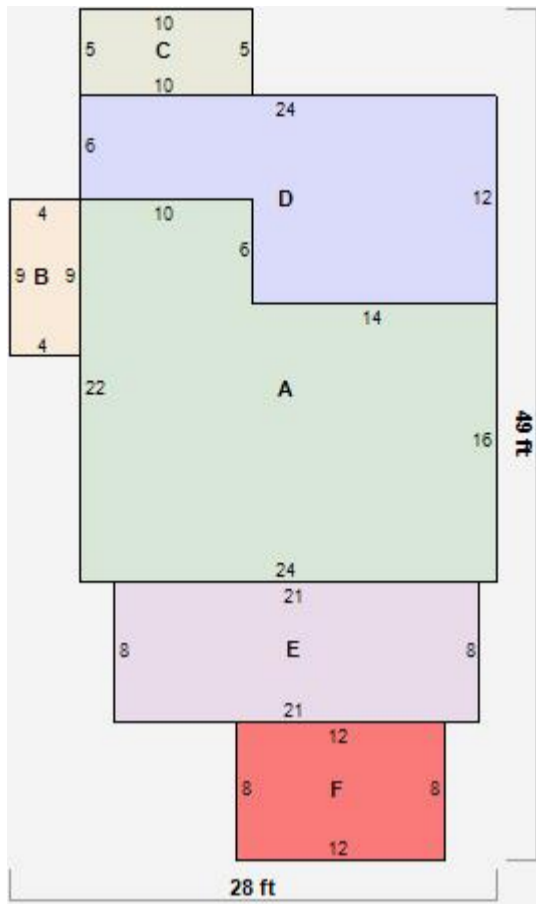

A	MAIN	444 square feet
B	EFP ENCL FRAME PORCH	36 square feet
C	EFP ENCL FRAME PORCH	50 square feet
D	1S FR ONE STORY FRAME	228 square feet
E	EFP ENCL FRAME PORCH	168 square feet
F	WDDCK WOOD DECKS	96 square feet

Parcel Images



Annual Taxes

Attention City of Erie Residents

Please be advised that due to the recent change in the billing cycle for the City of Erie school taxes, the total for Year 2012 (school tax column) will now include the total amounts for both the 2011-12 AND the 2012-13 tax years.

Year	County	City/Township	School	Library	Total
2024	293.35	459.33	0	0	752.68
2023	264.50	459.33	689.18	17.53	1430.54
2022	264.50	459.33	682.65	17.66	1424.14
2021	264.50	459.33	655.98	17.44	1397.25
2020	253.41	459.33	476.20	17.57	1206.51
2019	253.41	459.33	478.50	17.31	1208.55
2018	240.10	459.33	455.87	17.49	1172.79
2017	240.10	459.33	436.18	17.40	1153.01
2016	229.00	381.67	416.07	17.57	1044.31
2015	218.79	381.67	417.92	17.49	1035.87
2014	218.79	339.51	420.15	17.40	995.85
2013	218.79	339.51	450.52	22.19	1031.01
2012	258.46	369.53	576.60	16.91	1221.50
2011	258.46	369.53	593.63	16.56	1238.18
2010	258.46	322.54	589.29	16.47	1186.76
2009	232.82	322.54	579.52	14.88	1149.76
2008	222.14	309.72	600.32	14.87	1147.05
2007	211.46	309.72	29.74	0	550.92
2006	211.46	281.95	777.09	13.17	1283.67
2005	199.93	281.95	789.70	0	1271.58
2004	199.93	292.63	699.37	0	1191.93
2003	196.51	264.44	681.81	0	1142.76

Delinquent Taxes

Tax Year 2010	Tax	Penalty	Interest	Total	Paid/Exon	Balance
COUNTY	0.00	0.00	0.00	0.00	0.00	0.00
TWP/BORO/CITY	0.00	0.00	0.00	0.00	0.00	0.00
LIBRARY	0.00	0.00	0.00	0.00	0.00	0.00
SCHOOL	589.29	58.93	4.86	653.08	653.08	0.00
SCHOOL LIBRARY	16.47	1.65	0.14	18.26	18.26	0.00
<i>FEES</i>				36.00	36.00	0.00
2010 Total Due:						\$0.00

Tax Year 2019	Tax	Penalty	Interest	Total	Paid/Exon	Balance
COUNTY	253.41	25.34	25.09	303.84	303.84	0.00
TWP/BORO/CITY	459.33	45.93	45.47	550.73	550.73	0.00
LIBRARY	0.00	0.00	0.00	0.00	0.00	0.00
SCHOOL	478.50	47.85	47.37	573.72	573.72	0.00

SCHOOL LIBRARY	17.31	1.73	1.71	20.75	20.75	0.00
<i>FEES</i>				133.00	133.00	0.00
					2019 Total Due:	\$0.00

Tax Year 2020	Tax	Penalty	Interest	Total	Paid/Exon	Balance
COUNTY	253.41	25.34	0.00	278.75	278.75	0.00
TWP/BORO/CITY	459.33	45.93	0.00	505.26	505.26	0.00
LIBRARY	0.00	0.00	0.00	0.00	0.00	0.00
SCHOOL	0.00	0.00	0.00	0.00	0.00	0.00
SCHOOL LIBRARY	0.00	0.00	0.00	0.00	0.00	0.00
<i>FEES</i>				44.99	44.99	0.00
					2020 Total Due:	\$0.00

Tax Year 2021	Tax	Penalty	Interest	Total	Paid/Exon	Balance
COUNTY	264.50	26.45	6.55	297.50	297.50	0.00
TWP/BORO/CITY	459.33	45.93	11.37	516.63	516.63	0.00
LIBRARY	0.00	0.00	0.00	0.00	0.00	0.00
SCHOOL	655.98	65.60	16.24	737.82	737.82	0.00
SCHOOL LIBRARY	17.44	1.74	0.43	19.61	19.61	0.00
<i>FEES</i>				90.00	90.00	0.00
					2021 Total Due:	\$0.00

Tax Year 2022	Tax	Penalty	Interest	Total	Paid/Exon	Balance
COUNTY	264.50	26.45	30.45	321.40	321.40	0.00
TWP/BORO/CITY	459.33	45.93	52.88	558.14	558.14	0.00
LIBRARY	0.00	0.00	0.00	0.00	0.00	0.00
SCHOOL	682.65	68.27	78.59	829.51	829.51	0.00
SCHOOL LIBRARY	17.66	1.77	2.03	21.46	21.46	0.00
<i>FEES</i>				90.00	90.00	0.00
					2022 Total Due:	\$0.00

Tax Year 2023	Tax	Penalty	Interest	Total	Paid/Exon	Balance
COUNTY	264.50	26.45	10.91	301.86	0.00	301.86
TWP/BORO/CITY	459.33	45.93	18.95	524.21	0.00	524.21
LIBRARY	0.00	0.00	0.00	0.00	0.00	0.00
SCHOOL	689.18	68.92	28.43	786.53	0.00	786.53
SCHOOL LIBRARY	17.53	1.75	0.72	20.00	0.00	20.00
<i>FEES</i>				0.00	0.49	77.51
					2023 Total Due:	\$1,710.11
					Grand Total Due:	\$1,710.11

[Pay Delinquent Taxes](#)

Owner Info

PARCEL ID: 07-023-072.0-004.00

OWNER 1: PEREZ LUIS ET CASTILLA OLGA J

OWNER 2:

ADDRESS 1: 217 8TH ST

ADDRESS 2:

ADDRESS 3:

CITY: HICKSVILLE

STATE: NY

ZIP 1: 11801

ZIP 2:

LEGAL 1: 228 W SMITH ST TR 51 50X100

LEGAL 2:

LEGAL 3: